

ClimbingBASE

CLIMBING STRUCTURE IN STAINLESS STEEL

The system can be configured to suit any wall construction and is flexibly applicable to a wide range of building types. It enables large planting heights with few anchorage points, thereby providing the basis for a permanently load-bearing, low-maintenance and cost-effective installation. Load transfer is achieved via brackets or point foundations.

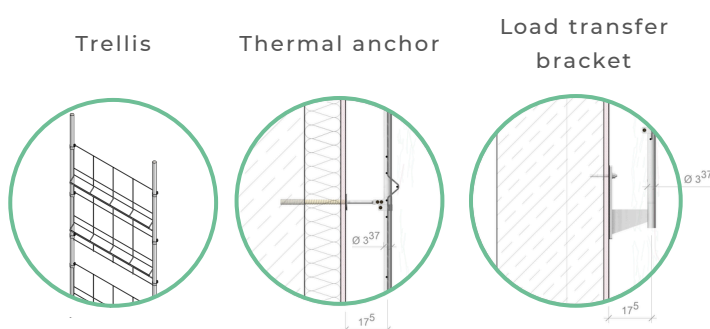

STRUCTURAL REQUIREMENTS

- Insulation thicknesses up to 350 mm
- Planting heights up to 15 m
- Building class 4
- Plant load classes 1 to 4
- Anchorages in concrete and solid masonry

PRODUCT SPECIFICATIONS

Trellis format:	965 x 2000 mm
System weight:	ca. 5 - 9 kg/m ² *
Materials and finishes:	Stainless steel (1.4301), pickled and passivated
Planting heights:	3,00 - 15,00 m
Centre-to-centre spacing:	1000 mm
Fire protection:	A1 – non-combustible
Structural system:	available

* Configuration-dependent average across the planted area, excl. plants.

CONTACT



Vertiko GmbH
Buchenhofener Straße 25 | 42329 Wuppertal
0202-947939-00 | anfrage@vertiko.de | vertiko.de

PRODUCT FEATURES

- Meets the highest standards for functionality and fire protection
- Corrosion-resistant thanks to high-quality stainless steel components
- Simple push-through installation
- Vertical support bars made from circular hollow sections
- Load transfer via brackets or point foundations

